

# Lifting Lugs

AVAILABLE FROM  
NEPEAN POWER

## Lifting Point



Part Number	Description
VLBG15T*	Lifting Point M42x4.5, 15T

\*Stocked Items

Part No.	Size	Rated Load WLL/T	M	mm												Nm	Weight/ KG
				A	B	C	D	E	F	G	H	L	S	SW			
VLBG15T	M42 x 4.5 - 6g	15	M42	95	104	112	36	63	256	158	86	149	24	65	1500	10.8	

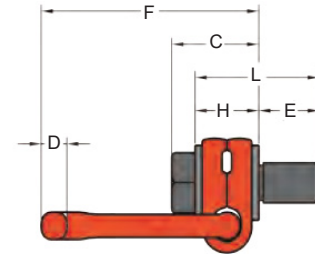
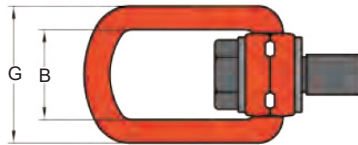
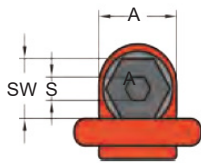

## Swivel Hoist Ring YD



Part Number	Description
YD-083-016*	Swivel Hoist Ring, Metric, Thread M16x2.0, Rated Load 1.8T (X) 2T (Y) 3.6(Z)

\*Stocked Item

Part No.	Size	I/T			mm										Weight/ KG
		X	(Y)	(Z)	A	B	C	D	E	F	G	M	T		
YD-083-016	M16 x 2.0 - 6g	1.3	(1.5)	(2.6)	13	42	30	40	37	31.8	44	16	96	0.5	

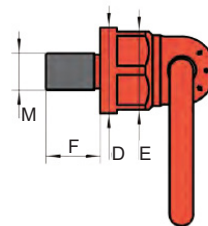
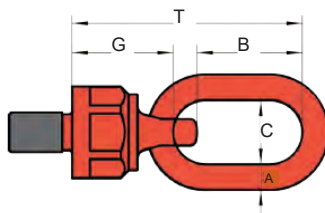

# Lifting Lugs



## Swivel Hoist Ring YDS

Part Number	Description
YDS - M16*	M16 YDS Swivel Hoist Ring 2T
YDS - M20*	M20 YDS Swivel Hoist Ring 3T
YDS - M30*	M30 YDS Swivel Hoist Ring 7.3T
YDS - M45*	M45 YDS Swivel Hoist Ring 15T

\*Stocked Items

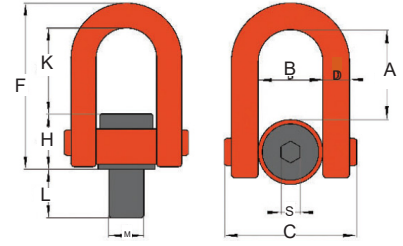

Part No.	Size	Rated Load WLL/T	Specification (mm)										Tightening Torque	Weight/ KG
			A	B	C	D	F	H	K	L	M	S		
YDS - M16	M16 x 2.0 - 6g	2T	49	37	76	14	106	40	50	24	16	10.5	150	0.77
YDS - M20	M20 x 2.5 - 6g	3T	73	54	107	20	150	53	77	40	20	14.5	250	2
YDS - M30	M30 x 3.5 - 6g	7.3T	100	74	150	30	200	69	104	45	30	22.5	500	5.4
YDS - M45	M45 x 4.5 - 6g	15T	100	74	150	30	200	69	104	63	45	22.5	1800	5.8

Lifting Method											
Spreader No.	1	2	1	2	2	2	3-4	3-4			
Lifting Angle	0°	0°	90°	90°	0-45°	45-60°	Askewed	0-45°	45-60°	Askewed	
Part No.	Thread	Rated Load/ T									
YDS - M16	16	2	4	2	4	2.8	2	2	4.2	3	2
YDS - M20	20	3	6	3	6	4.2	3	3	6.3	4.5	3
YDS - M30	30	7.3	14.6	7.3	14.6	10.2	7.3	7.3	15.3	11	7.3
YDS - M45	45	15	30	15	30	21	15	15	31.5	22.5	15



## G80 Lifting Point

Part Number	Description
FAB/LBS-01*	G80 Lifting Points 1.12T
FAB/LBS-03*	G80 Lifting Points 3.15T
FAB/LBS-05*	G80 Lifting Points 5.3T
FAB/LBS-10*	G80 Lifting Points 10T
YD-085-20*	G80 Lifting Points 20T

\*Stocked Items

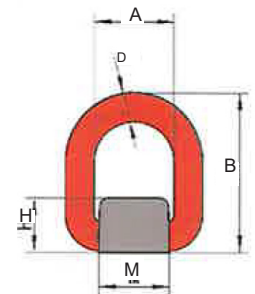

Part No.	Rated Load WLL/T	Specification (mm)					Weight/ KG
		A	B	D	M	H	
FAB/LBS-01	1.12T	41	78.5	13	37	35	0.4
FAB/LBS-03	3.15T	45	94	17	42.5	40	0.69
FAB/LBS-05	5.3T	55	118	22	61	52	1.46
FAB/LBS-10	10T	85	165	28	78	66	3.2
YD-085-20	20T	150	250	46	130	98	15.5