

Selector Switch



AVAILABLE FROM
NEPEAN ELECTRONICS

NEPEAN Power is a proven leader in the supply and manufacture of quality engineered solutions, products and technologies. Established in 1994, through the commitment of our dedicated team we have become a supplier of choice.

The NEPEAN Power LW26 series rotary switch mainly applies to 440V and below, AC 50HZ or 240V and below DC circuits. For breaking and closing, change-over of circuits under unfrequently manual operation.

The typical applications are: control switch of 3 phase motors, control switch of switch gear, control switch of instruments, and change-over switch of machinery and welding machines.

- The series comply with the GB 14048.3, GB 14048.5 and IEC 60947-3, ICE 60947-5-1.
- The LW26 series have 8 current ratings: 10A, 20A, 25A, 32A, 40A, 63A, 125A, 160A, 250A and 315A.
- They were designed for multiple functions, wide variety of applications.
- The LW26-20 have finger protection terminals.
- LW26 series rotary switch are an excellent substitute for LW2, LW5, LW6, LW8, LW12, LW15, HZ5, HZ10 and HZ12.
- The LW26 series rotary switch has two derivatives, LW26GS Pad-lock type and LW26S Key-lock type.
- Both of them are applicable in circuits when a physical control is required
- We can equip protective box (IP65) for 20A to 250A.

Working Conditions

- Ambient temperature DO NOT exceed 40°C, and the average temperature, measured over a period of 24 hours, DO NOT exceed 35°C
- Ambient temperature should not be below -25°C
- Should not be installed above 2000m above sea level
- The humidity should not exceed 50% when the ambient temperature is 40°C and higher humidity is allowed for lower temperature.

Ordering Information

Part Number	Description
LW-26-20-A004*	Volt meter selector switch, 4 position phase to phase.
LW-26-20-A048*	Ammeter selector switch, 4 position.
LW-26-20-A714*	EL test selector switch, UV TEST-OFF-ST TEST, spring return to centre
LW-26-20-A721*	Brake selector, 2 pole 2 position plate: off-on. Pad lockable in off positions

*Stocked Items

Selector Switch

Technical Specifications

Rated Thermal Current Iu/Ith/Ithe						
					A	20
Rated Insulation Voltage Ui ¹						
					V	690
Rated Impulse Withstand Voltage Uimp						
					kV	2.5
Rated Operational Current Ie						
AC-21A	Switching of resistive loads, including moderate overloads			A	20	
AC-22A	Switching of combined resistive or low inductive loads including moderate overloads		220V - 440V		20	
			660V - 690V		20	
AC-15	Switching of control devices, contactors, valves etc		220V - 240V	A	5	
			380V - 440V		4	
Rated Utilization Category						
AC-2	Slip ring motor starting, reversing and plugging, star-delta starting	3 phase	220V - 240V 380V - 440V	kW	4 7.5	
AC-3	Direct-on-line starting, star-delta starting	3 phase	220V - 240V 380V - 440V	kW	3 5.5	
		1 phase	220V - 240V 380V - 440V	kW	2.2 3	
AC-4	Direct-on-line starting, reversing, plugging and inching	3 phase	220V - 240V 380V - 440V	kW	0.55 1.5	
		1 phase	220V - 240V 380V - 440V	kW	0.75 1.5	
AC-23A	Frequent switching of motors or other high inductive loads	3 phase	220V - 240V 380V - 440V	kW	3.7 7.5	
		1 phase	220V - 240V 380V - 440V	kW	2.5 3.7	
Short Circuit Protection						
Rated Short-time withstand current		(1 s-current)		A	180	

LW-26-20-A004

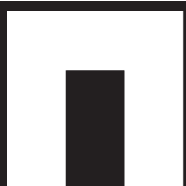
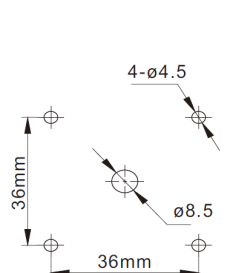
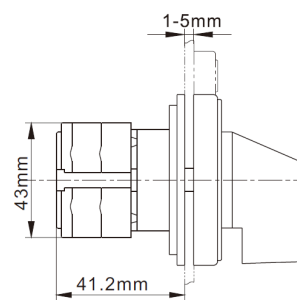
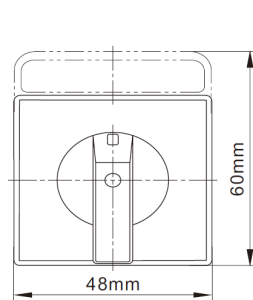
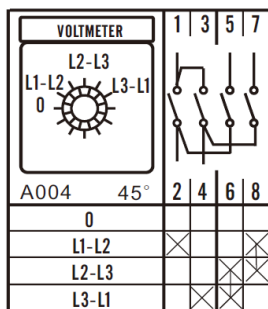

NEPEAN
Power

www.nepeanpower.com

For more information please contact:

P: +61 2 4088 2790

E: power@nepean.com

Selector Switch

LW-26-20-A048

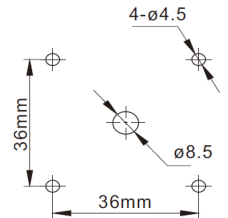
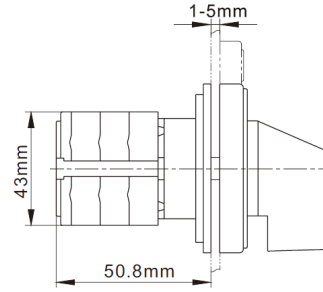
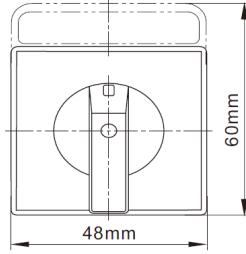
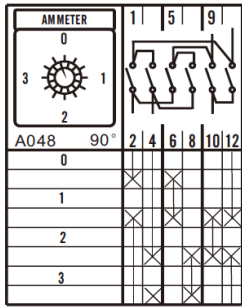

LW-26-20-A714

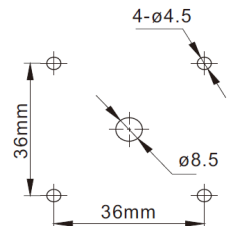
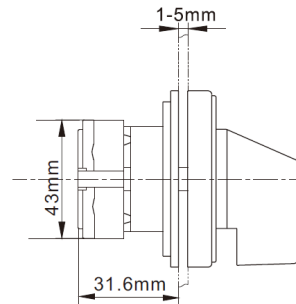
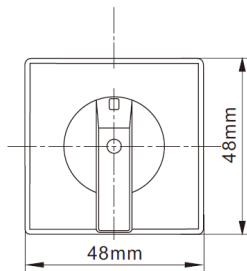
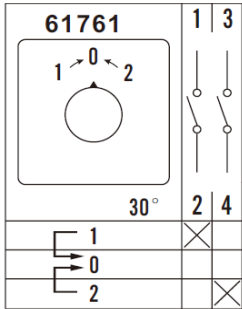

LW-26-20-A721

